

H3 160V Brushed DC Motor Specifications

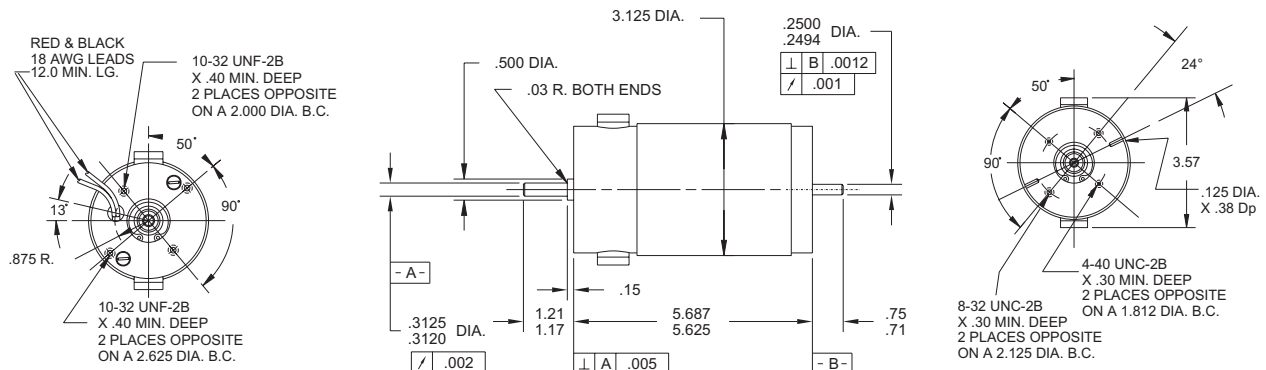

H3 Inline Version with Quick Disconnect (only dimensions that differ from above are shown)

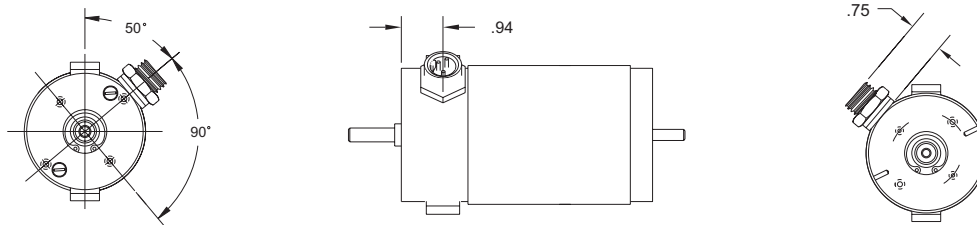

Motor Specifications		
Parameter	Units	Spec.
Rated Voltage	VDC	160
Max. Operating Voltage	VDC	180
Max. Continuous Current	Amps	2.0
Inductance	mH	25
K_t Torque Constant ($\pm 10\%$)	oz-in/A [N-m/A]	54 [0.38]
K_v Voltage Constant ($\pm 10\%$)	V/kRPM	40
Winding Resistance @ Ambient	Ohms	6.4
Continuous Stall Torque	oz-in [N-m]	108 [0.76]
No-load Speed at Rated Voltage	RPM	3900
Rotor Inertia	oz-in-s ² [kg-m ²]	0.049 [3.46]
Max. Winding Temperature	°F [°C]	180 [82]
Motor Weight	lbs [kg]	5.4 [2.45]

Note:
With red lead positive, shaft rotation is CCW viewed from the face of the motor.

Motor Wiring

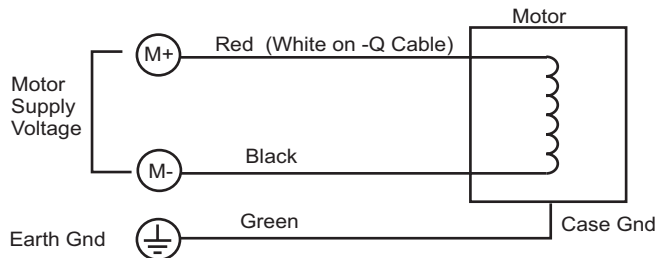

QUICK DISCONNECT

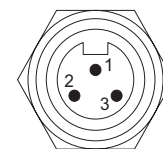

PIN 1- GND
PIN 2- NEG
PIN 3- POS